



THE FOURTH ANNUAL CONFERENCE ON EMPIRICAL LEGAL STUDIES

November 20-21, 2009, Los Angeles, California





**CELS Program Summary
November 20-21, 2009**

| Session | Start Times | End Times | Room 1 | Room 7 | Room 101 | Room 103 | Room 118/120 | Room 107 (Courtroom) | Room 130 | Room 2 | Room 114 |
|----------|-------------|-----------|---|--|--------------------|------------------------|-------------------------------|-----------------------------|------------------------|-------------------|--------------|
| Friday | | | | | | | | | | | |
| | 8:45 | 9:45 | Continental Breakfast and Registration Town and Gown | | | | | | | | |
| I. | 9:45 | 10:30 | Methodology I | | | | | Methodology II | | | |
| II. | 10:45 | 11:30 | Methodology III | | | | | Methodology IV | | | |
| | 11:30 | 1:00 | Lunch Town and Gown | | | | | | | | |
| III. | 1:00 | 3:00 | Corporate Governance I | Innovation & Growth | Law & Politics I | Law & Neuroscience | | Attitudes & Decision-making | Capital Punishment | | Tax |
| IV. | 3:15 | 5:15 | International Corporate Governance | Securities Litigation | Supreme Courts | Courts | Experimental Legal Studies I | Jurors | Policing | International Law | Law Schools |
| | 5:15 | 7:15 | Reception and Poster Session Town and Gown | | | | | | | | |
| Saturday | | | | | | | | | | | |
| | 7:30 | 9:00 | Continental Breakfast Town and Gown | | | | | | | | |
| I. | 9:00 | 10:20 | Organizational Form | Venture Capital | Law & Politics II | Elections I | Experimental Legal Studies II | Civil Rights | Torts | Environmental Law | Property I |
| II. | 10:35 | 12:35 | Corporate Governance II | Financial Regulation & Investor Protection | Law & Politics III | Elections II | Judging | Victims & Witnesses | Medical Malpractice I | Family Law | Property II |
| | 12:35 | 2:25 | Lunch and Keynote Speaker Town and Gown | | | | | | | | |
| III. | 2:25 | 4:25 | CEO Pay | Bankruptcy | Rule of Law | Campaigning & Lobbying | Behavioral Law & Economics | Criminal Evidence | Settlement | Legal Profession | Legal Origin |
| IV. | 4:40 | 6:00 | Corporate Governance III | Rating and Advertising Financial Products | Law & Politics IV | Election Audits | Administrative Law | Prisons | Medical Malpractice II | Patents | Contracts |

| | | | |
|-------------------------|--|--|-----------------------------|
| | Friday 8:45-9:45 AM | Continental Breakfast and Registration | Town and Gown |
| Friday | Methodology I | | ROOM 1 |
| Session I | Bernard S. Black | Interpreting Did and IV Estimates: ATE, LATE, ATET, and All That | |
| 9:45 - 10:30 AM | Methodology II | | ROOM 107 (Courtroom) |
| | Jonathan N. Katz | Time-Series, Cross-Section Methods | |
| Session II | Methodology III | | ROOM 1 |
| 10:45 - 11:30 AM | William Anderson, Martin T. Wells | Regression Techniques for Longitudinal Data and Data with a Large Proportion of Zeros | |
| | Methodology IV | | ROOM 107 (Courtroom) |
| | Jasjeet S. Sekhon | Casual Inference, Matching, and Regression Discontinuity | |
| | Friday 11:30-1:00 PM | LUNCH | Town and Gown |
| | AUTHOR | PAPER | DISCUSSANT |
| Session III | Innovation and Growth | Chair: Gillian Hadfield | ROOM 7 |
| 1:00 - 3:00 PM | Stuart J. H. Graham, Robert P. Merges, Pamela Samuelson, Ted M. Sichelman | High Technology Entrepreneurs and the Patent System: Results of the 2008 Berkeley Patent Survey | Kathleen Allen |
| | Anup Agrawal, Tommy Cooper | Accounting Scandals in IPO Firms: Do Underwriters and VCs Help? | David Walker |
| | James C. Spindler | IPO Underpricing, Disclosure, and Litigation Risk | Kenneth Ayotte |
| | Corporate Governance I | Chair: Anh Tran | ROOM 1 |
| | Kose John, Lubomir P. Litov | Corporate Governance and Financing Policy: New Evidence | Ehud Kamar |
| | Yair Jason Listokin | If You Give Shareholders Power, Do They Use It? An Empirical Analysis | Assaf Hamdani |
| | Chenyang (Jason) Wei, David Yermack | Stockholder and Bondholder Reactions to Revelations of Large CEO Inside Debt Holdings: An Empirical Analysis | Arthur Korteweg |
| | Law and Politics I | Chair: Andrew Martin | ROOM 101 |
| | Jeffrey R. Lax, Kelly T. Rader | Legal Constraints on Supreme Court Decision Making: Do Jurisprudential Regimes Exist? | Kevin Quinn |
| | Tom S. Clark | Locating Supreme Court Opinions in Doctrine Space | David Law |
| | Matthew Gabel, Clifford Carrubba | The European Court of Justice as an Engine of Economic Integration: Reconsidering Evidence that the ECJ has Expanded Economic Exchange in Europe | Charles Cameron |

| | AUTHOR | PAPER | DISCUSSANT |
|--|---|---|-----------------------|
| Friday Session III 1:00 - 3:00 PM (Cont.) | Capital Punishment | Chair: Rebecca Sandefur | ROOM 130 |
| | Mona Lynch Craig Haney | The Exceptionalism of the White Male Capital Juror: Race and Sentencing in a Mock Jury Experiment | Shari Seidman Diamond |
| | Barbara O'Brien, Chen Hu, Samuel R. Gross | Estimating the Probability of False Conviction for Criminal Defendants Who are Sentenced to Death | Richard John |
| | Franklin E. Zimring Jeffrey Fagan, David T. Johnson | Executions, Deterrence and Homicide: A Tale of Two Cities | David Abrams |
| | Attitudes and Decision-making | Chair: Dawn McQuiston | ROOM 107 |
| | Dan M. Kahan | Culture, Cognition, and Consent: Who Perceives What, and Why, in 'Acquaintance Rape' Cases | Phoebe C. Ellsworth |
| | Nicholas J. Schweitzer , Michael J. Saks, David Lovis-McMahon | Is the Rule of Law a Law of Rules? Judgments of Rule of Law Violations | Stephan Landsman |
| | Avishalom Tor , Oren Gazal-Ayal, Stephen M. Garcia | Fairness and the Willingness to Accept Plea Bargain Offers | Joshua Fischman |
| | Law and Neuroscience | Chair: Mark Turner | ROOM 103 |
| | Christopher L. Asplund, Joshua Buckholtz, Paul E. Dux, John C. Gore Owen D. Jones , Rene Marois, David H. Zald | The Neural Correlates of Third-Party Punishment | Isabelle Brocas |
| | Oliver R. Goodenough | Strategic Mechanisms, Functional Modeling and Experimental Design in Neurolaw | Mark Turner |
| | Paul J. Zak | The Physiology of Moral Sentiments | Cheryl Boudreau |
| | Tax | Chair: Scott Altman | ROOM 114 |
| | Dhammika Dharmapala , C. Fritz Foley, Kristin J. Forbes | Watch What I Do, Not What I Say: The Unintended Consequences of the Homeland Investment Act | Edward Kleinbard |
| | Lilian V. Faulhaber , Daniel Martin Katz, Michael J. Bommarito II | A Tale of Two Codes: An Empirical Analysis of the Jurisprudence of the United States Tax Court (1990-2008) | James Spriggs |
| | Sagit Leviner , Kyle Richison | The Role Paid Preparers Play in Taxpayer Compliance in the United States: An Empirical Investigation with Policy Implications | Theodore Seto |

| | AUTHOR | PAPER | DISCUSSANT |
|---|--|---|-------------------|
| Friday Session IV 3:15 - 5:15 PM | International Corporate Governance | Chair: Bruce Kobayashi | ROOM 1 |
| | Kate Litvak | The Relationship Among U.S. Securities Laws, Cross-Listing Premia, and Trading Volumes | Yair Listokin |
| | Ryan T. Ball, Luzi Hail , Florin P. Vasvari | Equity Cross-Listings in the U.S. and the Price of Debt | Oguzhan Ozbas |
| | Reena Aggarwal, Isil Erel, Miguel A. Ferreira, Pedro P. Matos | Does Governance Travel Around the World? Evidence from Institutional Investors | Holger Spamann |
| | Securities Litigation | Chair: Ahmed Taha | ROOM 7 |
| | Michael D. Klausner | Are Securities Class Actions 'Supplemental' to SEC Enforcement? An Empirical Analysis | Adam C. Pritchard |
| | Stephen J. Choi, Adam Pritchard | The Supreme Court's Impact on Securities Class Actions: An Empirical Assessment of Tellabs | Charles Silver |
| | Jonah B. Gelbach, Eric A. Helland , Jonathan Klick | Does <i>Dura</i> Matter? Loss Causation and the Implications of <i>Dura Pharmaceuticals v. Broudo</i> | Alicia J. Davis |
| | International Law | Chair: Keren Weinshall Margel | ROOM 2 |
| | Joseph W. Doherty , Richard H. Steinberg | An Empirical Study of ICTY and ICTR Sentencing: Doctrine Versus Practice | Kim Buchanan |
| | Alan Tauber | Explaining Decision-Making by Supreme Court Justices in Cases Involving International Law | Emerson Tiller |
| | Mostafa Beshkar | Estimating a Model of Settlement Bargaining in the World Trade Organization | Mark Van Boening |
| | Policing | Chair: Jan Leighley | ROOM 130 |
| | Andrea Cann Chandrasekher | The Effect of Order-Maintenance Policing on Serious and Non-Serious Crime: Evidence from a Quasi-Experiment | Paul Heaton |
| | Amanda B. Geller , Jeffrey Fagan | Doubling Down on Pot: Marijuana, Race and the New Disorder in New York City Street Policing | Robert MacCoun |
| | Katherine M. Knight Tuttle | Implicit Racial Attitudes and Law Enforcement Shooting Decisions | Samuel Gross |

| | AUTHOR | PAPER | DISCUSSANT |
|---|--|---|---------------------------------|
| Friday Session IV 3:15 - 5:15 PM (Cont.) | Law Schools | Chair: Michele DeStefano Beardslee | ROOM 114 |
| | Paul Oyer, Scott Schaefer | The Returns to Attending a Prestigious Law School | Richard Sander |
| | Ming M. Zhu | Racing to the Top: An Empirical Study of the Effect of Race in Entry-Level Law School Hiring | Katherine Barnes |
| | Marjorie M. Shultz, Sheldon Zedeck | Predicting Lawyer Effectiveness: A New Assessment for Use in Law School Admission Decisions | Gillian Hadfield |
| | Supreme Courts | Chair: Clifford Carrubba | ROOM 101 |
| | Daniel E. Ho, Kevin M. Quinn | Did a Switch in Time Save Nine? | Jasjeet Sekhon |
| | Gregory A. Caldeira, John (Jack) R. Wright | Organized Interests Before the Supreme Court: Setting the Agenda, 1968-1990 | Anthony Bertelli |
| | Nuno M. Gagroupa, Veronica Grembi, Shirley Ching-ping Lin | Explaining Constitutional Review in New Democracies: The Case of Taiwan | Lydia Brashear Tiede |
| | Jurors | Chair: Jeb Barnes | ROOM 107 (Courtroom) |
| | Cynthia G. Lee | Twelve Merry Men? Confronting the Legend of the Robin Hood Jury | Jeb Barnes |
| | Jerry Kang, Nilanjana Dasgupta, Kumar Yogeewaran, Gary Blasi | Are Ideal Litigators White? Measuring the Myth of Colorblindness | Jeremy Horowitz |
| | Erin York Cornwell, Valerie P. Hans | Contextualizing Jury Participation: Case-, Jury-, and Juror-Level Predictors of Participation in Jury Deliberations | Andrea Jones-Rooy |
| | Courts | Chair: Gregory Keating | ROOM 103 |
| | Jeff L. Yates, Paul Brace, Brent D. Boyea | Judges, Litigants and the Design of Courts | Daniel Mazmanian |
| | Thomas H. Cohen | When is the Verdict or Judgment Final?: An Examination of Post Trial Activity in Civil Litigation | Gregory Keating |
| | Brian T. Fitzpatrick | Class Action Settlements and Their Fee Awards | Deborah Hensler |
| | Experimental Legal Studies I | Chair: Paul J. Zak | ROOM 118/120 |
| | Isabelle Brocas, Juan D. Carrillo, Thomas R. Palfrey | Information Gatekeepers: Theory and Experimental Evidence | Michael Bommarito |
| | Kevin M. Esterling, David Lazer, Michael A. Neblo | Explaining the Diffusion of Web-Based Communication Technology among Congressional Offices: A Natural Experiment Using State Delegations | Paul J. Zak |
| | Cheryl Boudreau, Mathew D. McCubbins, Daniel B. Rodriguez, Nicholas Weller | Opting in or Opting Out: The Conditions for Developing Consensus | Oliver Goodenough |

| Friday 5:15-7:15 PM | | Reception & Poster Session | Town and Gown |
|---|--|--|----------------------|
| Friday 5:15 - 7:15 PM Reception & Poster Session | POSTER SESSION | | |
| | Poster Session: Corporate and Securities Law | | Town and Gown |
| | Quinn Curtis | Agency Costs and the Price Effects of Corporate Litigation | |
| | David C. Cicero, Modupe Babajide Wintoki, Tina Yang | Do Firms Adjust to a Target Board Structure? | |
| | David I. Walker | Evolving Executive Equity Compensation and the Limits of Optimal Contracting | |
| | Eliezer M. Fich, Anh L. Tran, Ralph A. Walking | On the Importance of Golden Parachutes | |
| | Poster Session: Crime | | Town and Gown |
| | Justin McCrary | Assessing the Crime Impact of Sexually Violent Predator Laws | |
| | Hadar Aviram Annick M. Persinger | Perceiving and Reporting Domestic Violence Incidents in Unconventional Settings: A Vignette Survey Study | |
| | Libor Dusek, Fusako Tsuchimoto | Responses to More Severe Punishment in the Courtroom: Evidence from Truth-in-Sentencing Laws | |
| | Poster Session: Law and Politics | | Town and Gown |
| | Robert Anderson IV | Distinguishing Judges: An Empirical Ranking of Judicial Quality in the U.S. Court of Appeals | |
| | Maeve P. Carey | Dodging Conflict: The Supreme Court Under Threat from Congress | |
| | Eileen McDonagh, Michael Tolley | Empowering Democratic Citizenship: The Welfare State as Constitutional Rights and Government Spending | |
| | Benedikt Goderis, Mila Versteeg | Human Rights Violations after 9/11 and the Role of Constitutional Constraints | |
| | Menachem Hofnung, Keren Weinshall Margel | Judicial Setbacks, Material Gains: Terror Litigation at the Israeli HCJ | |
| | Jennifer L. Merolla, Elizabeth J. Zechmeister, Travis Coan | Polluting the Reservoir: Conditions of Threat and Support for Democracy in Mexico and the United States | |
| | Darryn C. Beckstrom | Renomination of Judicial Nominees to the U.S. District Court and U.S. Court of Appeals | |
| | Poster Session: Law and Psychology | | Town and Gown |
| | Gail S. Goodman, Stephanie D. Block, Daisy A. Segovia, Jennifer M. Schaaf, Kristen Weede Alexander, Donna Shestowsky | Adults' Abilities to Discern Children's True and False Memories | |
| | Christopher T. Robertson | Beyond Disclosure: An Emirical Investigation of Unbiased Advice as the Key to Protecting Laypersons | |
| | Jeffrey J. Rachlinski, Chris Guthrie, Andrew J. Wistrich | Context Effects in Judicial Decision Making | |
| | Dan Simon, Doug Stenstrom, Stephen J. Read | Partisanship and Prosecutorial Decision Making: An Experiment | |

| Friday 5:15-7:15 PM | | Reception & Poster Session | Town and Gown |
|---|--|---|----------------------|
| Friday 5:15 - 7:15 PM Reception & Poster Session (Cont.) | POSTER SESSION | | |
| | Poster Session: Litigation and Damages | | Town and Gown |
| | Charles N.W. Keckler | Cy Pres and Its Predators | |
| | Seth Seabury, Nicholas M. Pace | Do Caps on Damage Awards Crowd Out Judicial Oversight of Civil Jury Verdicts? | |
| | Paul Heaton, Eric A. Helland | Judicial Expenditures and Access to Justice: Evidence from Auto Injuries | |
| | Theodore Eisenberg, Michael Heise, Nicole L. Waters, Martin T. Wells | The Decision to Award Punitive Damages: An Empirical Study | |
| | Poster Session: Precedent and Networks | | Town and Gown |
| | Anthony Niblett | Are Citations of Precedent Merely Ex Post Justifications of Extra-Legal Decisions? | |
| | Daniel M. Katz, Joshua Gubler, Jon Zelner, Eric A. Provins, Eitan M. Ingall | Reproduction of Hierachy? A Social Network Analysis of the American Law Professoriate | |
| | Ryan C. Black, James F. Spriggs II | The Depreciation of Precedent on the U.S. Supreme Court | |
| | Michael J. Bommarito II, Jon Zelner, Daniel M. Katz, John H. Fowler | Distance Measures for Dynamic Citation Networks | |
| | Poster Session: Regulation, R&D and Development | | Town and Gown |
| | Josef Montag | Do Legal Origins Help to Explain International Differences in Gender-Income Ratio? | |
| | Terra Lawson-Remer | Security of Property Rights for Whom? | |
| | Brian Chen | Stark Contrasts: The Impact of Prohibiting Physician Self-Referrals on the Prevalence of Overtreatment in Health Care | |
| | John Hagedoorn, Geerte Hesen | Contractual Complexity of R&D Alliances - A Two-Dimensional Analysis of the Determinants of Contractual Complexity | |

| | Saturday 7:30-9:00 AM | Continental Breakfast and Registration | Town and Gown |
|---|--|--|-------------------------|
| | AUTHOR | PAPER | DISCUSSANT |
| Saturday Session I 9:00 - 10:20 AM | Organizational Form | Chair: Roberta Romano | ROOM 1 |
| | Timothy W. Guinnane, Jean-Laurent Rosenthal | Making Do with Imperfect Law: Small Firms in France and Germany 1890-1935 | Larry E. Ribstein |
| | Bruce H. Kobayashi, Larry E. Ribstein | Jurisdictional Competition for Limited Liability Companies | Jens Dammann |
| | Venture Capital | Chair: Kate Litvak | ROOM 7 |
| | Sonali Hazarika, Rajarishi Nahata, Kishore Tandon | Success in Global Venture Capital Investing: Do Institutional and Cultural Differences Matter? | Duke Bristow |
| | Brian J. Broughman, Jesse M. Fried | Do VCs Use Inside Financing to Dilute Founders? | Tom Chang |
| | Elections I | Chair: Lynn Vavreck | ROOM 103 |
| | D. James Greiner, Kevin M. Quinn | Exit Polling and Racial Bloc Voting: Combining Individual-Level and R x C Ecological Data | Jeffrey Lewis |
| | Jan E. Leighley, Jonathan Nagler | Electoral Laws and Turnout: 1972-2008 | Lynn Vavreck |
| | Civil Rights | Chair: Thomas Griffith | ROOM 107 (Courtroom) |
| | Calvin Morrill | Legal Mobilization in U.S. Schools: The Paradoxes of Race and Rights Among Youth | Laura Gomez |
| | Joanna C. Schwartz | Myths and Mechanics of Deterrence: Litigation, Information, and Decision-Making | Thomas Griffith |
| | Environmental Law | Chair: David Stras | ROOM 2 |
| | Paulina Oliva | Environmental Regulations and Corruption: Automobile Emissions in Mexico City | David Stras |
| | Wendy E. Wagner, Katherine Y. Barnes, Lisa K. Peters | Air Toxics in the Board Room: An Empirical Study of EPA's Hazardous Air Pollutant Rules | Dean Lueck |

| | AUTHOR | PAPER | DISCUSSANT |
|---|---|---|---------------------|
| Saturday Session I 9:00 - 10:20 AM (Cont.) | Law and Politics II | Chair: Nathan Monroe | ROOM 101 |
| | Ryan J. Owens, Ryan C. Black | Estimating the Policy Preferences of United States Courts of Appeals Judges | Chris Den Hartog |
| | David S. Law, David T. Zaring | Law Versus Ideology: The Supreme Court and the Use of Legislative History | Jeffrey Lax |
| | Property I | Chair: John Strauss | ROOM 114 |
| | Stanislav Markus | Secure Property as a Bottom-Up Process: Firms, Stakeholders, and Predators in Weak States | Jefferey Sellers |
| | Ryan Bubb | States, Law, and Property Rights in West Africa | Harold Demsetz |
| | Experimental Legal Studies II | Chair: Mathew McCubbins | ROOM 118/120 |
| | Richard R. W. Brooks, Claudia M. Landeo, Kathryn E. Spier | Trigger Happy or Gun Shy: Dissolving Common-Value Partnerships with Texas Shootouts | Mathew McCubbins |
| | Kristoffel Grechenig, Andreas Nicklitsch, Christian Thoeni | Punishment Despite Reasonable Doubt - A Public Goods Experiment with Uncertainty over Contributions | Brad LeVeck |
| | Torts | Chair: Paul Heaton | ROOM 130 |
| | Neil Vidmar, Mirya R. Holman | The Frequency, Predictability and Proportionality of Punitive Damages in State Courts | Theodore Eisenberg |
| | Issa Kohler-Hausmann | Community Characteristics and Tort Law: The Importance of County Demographics and Inequality to Tort Trial Outcomes | Michael Heise |

| | AUTHOR | PAPER | DISCUSSANT |
|---|--|---|---------------------|
| Saturday Session II 10:35 - 12:35 PM | Corporate Governance II | Chair: Rajarishi Nahata | ROOM 1 |
| | Modupe Babajide Wintoki, James S. Linck, Jeffry M. Netter | Endogeneity and the Dynamics of Corporate Governance | Martin Wells |
| | Martijn Cremers, Allen Ferrell | Thirty Years of Corporate Governance: Firm Valuation & Stock Returns | Rob Daines |
| | Lucian A. Bebchuk, Ehud Kamar | Bundling and Entrenchment | Volkan Muslu |
| | Financial Regulation and Investor Protection | Chair: Mark Weinstein | ROOM 7 |
| | Ludovic Moreau | Regulatory Versus Informational Value of Bond Ratings: Hints from History | Michael Klausner |
| | Cindy R. Alexander, Kathleen Weiss Hanley | Regulatory Monitoring Under the Sarbanes- Oxley Act | Roberta Romano |
| | Ashwini K. Agrawal | The Impact of Investor Protection Law on Corporate Policy: Evidence from the Blue Sky Laws | Cindy Alexander |
| | Family Law | Chair: Jonah Gelbach | ROOM 2 |
| | I. Glenn Cohen, Daniel L. Chen | Trading Off Reproductive Technology and Adoption: Do IVF Subsidies Decrease Adoption Rates? | Jonathan Klick |
| | Alma Cohen, Rajeev H. Dehejia, Dmitri Romanov | Financial Incentives and Fertility | Tiffany Chou |
| | Marjorie B. McElroy | The Dimensions of Divorce Laws: Waiting Times, No-Fault and Unilateral Divorce Laws | Maria Casanova |
| | Judging | Chair: Jeffrey Staton | ROOM 118/120 |
| | Timothy R. Johnson, Ryan Black, Justin Wedeking | Oral Arguments and the Process of Coalition Formation on the U.S. Supreme Court | Jeffrey Staton |
| | Rachel Dioso-Villa | Fire in the Hole: Empirical Testing of a Pro-Government/Anti-Plaintiff Bias in the Admissibility of Scientific Experts in Criminal and Civil Cases | Neil Vidmar |
| | Max M. Schanzenbach, Joshua B. Fischman | Do Standards of Review Matter? The Case of Federal Criminal Sentencing | Lydia Tiede |
| | Elections II | Chair: Marisa Abrajano | ROOM 103 |
| | Christopher R. Berry, Jacob E. Gersen | The Timing of Elections | Nathan Monroe |
| | Jasjeet S. Sekhon, Rocio Titiunik | Redistricting and the Personal Vote: When Natural Experiments are Neither Natural Nor Experiments | Daniel Enemark |
| | Daniel Hopkins | Language Access and Initiative Outcomes: Did the Voting Rights Act Reduce Support for Bilingual Education? | Marisa Abrajano |

| | AUTHOR | PAPER | DISCUSSANT |
|---|---|---|---------------------------------------|
| Saturday Session II 10:35 - 12:35 PM (Cont.) | Victims and Witnesses | Chair: Lauren Fasig | ROOM 107 (Courtroom) |
| | Elizabeth Kellstrand, Jodi Quas, Maria Sumaroka, Steven E. Clark, Rakel Larson | Stress, Supportive Interviewing, and Children's Identification Accuracy | Steven Penrod |
| | Robyn Carbone Licht, Lindsay Erin Wandrey, Elizabeth C. Ahern, Alexia Cooper, Megan Sim, Jodi Quas, Thomas D. Lyon | The Effect of Rapport Building and Putative Confessions Upon Maltreated and Nonmaltreated Children's Disclosure of a Minor Transgression | Myrna Raeder |
| | Jordan D. Matsudaira, Emily Greene Owens | The Economics of Rape: Will Victims Pay for Police Involvement? | Daniel Chen |
| | Medical Malpractice I | Chair: Jill Horwitz | ROOM 130 |
| | David A. Hyman, Bernard S. Black, Charles M. Silver | The Impact of the 'Duty to Settle' on Settlement: Evidence from Texas | Max Schanzenbach |
| | Michael D. Greenberg, Steven Garber | Patterns of Specialization in Medical Malpractice Among Contingency Fee Attorneys | Herbert Kritzer |
| | Ronen Avraham, Leemore S. Dafny, Max M. Schanzenbach | The Impact of Tort Reform on Employer- Sponsored Health Insurance Premiums | John Romley |
| | Law and Politics III | Chair: Nina Walton | ROOM 101 |
| | Marcus E. Hendershot | Twisted Roots: Cointegrated Explanations of Transformation within the Federal Judicial Appointment Process | Nina Walton |
| | Daniel E. Ho, Erica L. Ross | Did Liberal Justices Invent the Standing Doctrine? An Empirical Study of the Evolution of Standing, 1921-2006 | Linda Cohen |
| | James F. Spriggs, David R. Stras | Why the Supreme Court Issues Plurality Opinions | Amihai Glazer |
| | Property II | Chair: Terra Lawson-Remer | ROOM 114 |
| | Yun-chien Chang | An Empirical Study of Court-Adjudicated Takings Compensation in New York City: 1990- 2003 | Paige Marta Skiba |
| | Gary D. Libecap, Dean Lueck | The Demarcation of Land and the Role of Coordinating Institutions | Ryan Bubba |
| | Daniel E. Bogart | Did the Glorious Revolution Contribute to the Transport Revolution? Evidence from Investment in Roads and Rivers | Tracy Dennison |

| | | | |
|--|--|---|----------------------|
| | 12:35-2:25 PM | Lunch and Keynote Welcome Remarks: Dean Robert Rasmussen Keynote Speaker: Theodore Eisenberg | Town and Gown |
| | AUTHOR | PAPER | DISCUSSANT |
| Saturday Session III 2:25 - 4:25 PM | CEO Pay | Chair: Dragon Yongjun Tang | ROOM 1 |
| | Anup Agrawal , Tareque Nasser | Blockholders on Boards and CEO Compensation, Turnover and Firm Valuation | Amir Licht |
| | Yonca Ertimur, Volkan Muslu , Fabrizio Ferri | Shareholder Activism and CEO Pay | H. Shawn Mobbs |
| | David A. Maber , Fabrizio Ferri | Say on Pay Votes and CEO Compensation: Evidence from the UK | Quinn Curtis |
| | Bankruptcy | Chair: Robert Rasmussen | ROOM 7 |
| | Nellie Liang, Antonio Falato | Do Creditor Rights Increase Employment Risk? Evidence from Debt Covenants | Edward Morrison |
| | Wenli Li, Michelle J. White , Ning Zhu | Did Bankruptcy Reform Contribute to the Mortgage Crisis? | Richard Green |
| | Vedran Capkun , Evren Ors | When Congress Says "Pip Your Kerp": Performance Incentive Plans, Key Employee Retention Plans and, Chapter 11 Bankruptcy Resolution | James Spindler |
| | Settlement | Chair: Bart Kosko | ROOM 130 |
| | Kong-Pin Chen, Kuo-Chang Huang , Chang-Ching Lin | An Empirical Investigation of Settlement & Litigation - The Case of Taiwan Labor Disputes | Mostafa Beshkar |
| | Hilary A. Sigman , Howard F. Chang | An Empirical Analysis of Cost Recovery in Superfund Cases: Implications for Brownfield and Joint and Several Liability | Wendy Wagner |
| | Paul Pecorino, Mark Van Boening | Bargaining with Asymmetric Dispute Costs | Kathryn Zeiler |
| | Rule of Law | Chair: Barry Weingast | ROOM 101 |
| | Lydia Brashear Tiede , Daniel B. Rodriguez | Explaining the Variance in Federal Immigration Prosecution: Should National Policy Control a Largely Local Endeavor | Pablo Spiller |
| | Julio Rios-Figueroa, Jeffrey K. Staton | Unpacking the Rule of Law: A Review of Judicial Independence Measures | Barry Weingast |
| | Sebastian M. Saiegh | Political Institutions and Sovereign Borrowing: Evidence from Nineteenth-Century Argentina | D. Roderick Kiewiet |
| | Legal Profession | Chair: Rebecca Sandefur | ROOM 2 |
| | Art Hinshaw , Jess K. Alberts | Doing the Right Thing: An Empirical Study of Attorney Negotiation Ethics | Russell Korobkin |
| | Michele DeStefano Beardslee , Ashish Nanda, David Wilkins, John C. Coates | Hiring Teams from Rivals: Theory and Evidence on the Evolving Relationships in the Corporate Legal Market | Tanina Rostain |
| | C.N.V. Krishnan, Ronald W. Masulis | Law Firm Reputation and Mergers and Acquisitions | John Coates |

| | AUTHOR | PAPER | DISCUSSANT |
|--|--|--|---------------------------------------|
| Saturday Session III 2:25 - 4:25 PM (Cont.) | Campaigning and Lobbying | Chair: Matthew Beckmann | ROOM 103 |
| | James L. Gibson, Gregory A. Caldeira | Campaign Support, Conflicts of Interest, and Judicial Impartiality: Can the Legitimacy of Courts Be Rescued by Recusals? | Matthew Beckmann |
| | Nina Walton, Nicholas Weller | Moral Hazard in Campaigns: Do Political Candidates keep hiring their Consultants? | Craig Burnett |
| | John M. de Figueiredo, Charles M. Cameron | Endogenous Cost Lobbying: Theory and Evidence | Keith Poole |
| | Criminal Evidence | Chair: Judge Stephanie Domitrovich | ROOM 107 (Courtroom) |
| | Steven E. Clark | Trade-Off in Correct and False Identifications: Protecting the Innocent is Not Free | Michael Saks |
| | Jonathan J. Koehler | The Probative Value of Forensic Science Evidence | John Rolph |
| | Simon A. Cole | Speaking of Evidence: An Empirical Study of the Reporting of Forensic Conclusions in US Criminal Trials | Jennifer Mnookin |
| | Behavioral Law and Economics | Chair: Gijs Van Dijck | ROOM 118/120 |
| | Tess Wilkinson-Ryan, David A. Hoffman | Breach Is For Suckers | Lynn Stout |
| | Kenworthy Bilz | Integrity or Deterrence? The Psychology of the Exclusionary Rule | Dan Simon |
| | Donald Braman, Dan M. Kahan, David A. Hoffman | Some Realism About Punishment Naturalism | Lawrence Solan |
| | Legal Origin | Chair: Josef Montag | ROOM 114 |
| | Holger Spamann | The Global Cross-Section of Crime and Punishment | Jeffrey Fagan |
| | Daniel Berkowitz, Karen B. Clay | Institutional Hysterisis: Courts and Politics in the American States (Chapters 5 & 6 of a Book Project) | John Matsusaka |
| | Daniel M. Klerman, Paul Mahoney, Holdger Spamann, Mark Ira Weinstein | Legal Origin and Economic Growth | Karen B. Clay |

| | AUTHOR | PAPER | DISCUSSANT |
|---|---|---|---------------------------------------|
| Saturday Session IV 4:40 - 6:00 PM | Prisons | Chair: Katherine Barnes | ROOM 107 (Courtroom) |
| | Richard T. Boylan, Naci Mocan | Intended and Unintended Consequences of Prison Reform | Jeffrey Rachlinski |
| | Francesco Drago, Roberto Galbiati, Pietro Vertova | Prison Conditions and Recidivism | Justin McCrary |
| | Rating and Advertising Financial Products | Chair: Michelle White | ROOM 7 |
| | John M. Griffin, Dragon Yongjun Tang | Did Subjectivity Play a Role in CDO Credit Ratings? | Stephane Rousseau |
| | Molly Mercer, Alan R. Palmiter, Ahmed E. Taha | Worthless Warnings? Testing the Effectiveness of Disclaimers in Mutual Fund Advertisements | Geoffrey Miller |
| | Election Audits | Chair: Kevin Quinn | ROOM 103 |
| | Jonathan Katz, R. Michael Alvarez, Erin Hartman, Sarah Hill | Evaluating Random Election Audits | Nicholas Weller |
| | Philip B. Stark | Efficient Post-Election Audits of Multiple Contests: 2009 California Tests | Adam Glynn |
| | Contracts | Chair: Gillian Hadfield | ROOM 114 |
| | Yannis Bakos, Florencia Marotta-Wurgler, David R. Trossen | Does Anyone Read the Fine Print? Testing a Law and Economics Approach to Standard Form Contracts | Zev Eigen |
| | Adam B. Badawi | Relational Governance and Contract Damages: Evidence from Franchising | Jonathan Klick |
| | Corporate Governance III | Chair: Donald Scotten | ROOM 1 |
| | H. Shawn Mobbs | CEOs Under Fire: Pressure from Within: The Effects of Inside Directors on CEO Compensation and Turnover | Jonah Gelbach |
| | Renée B. Adams, Amir N. Licht, Lilach Sagiv | Shareholderism: Board Members' Values and the Shareholder-Stakeholder Dilemma | Modupe Wintoki |

| | AUTHOR | PAPER | DISCUSSANT |
|---|---|--|---------------------|
| Saturday Session IV 4:40 - 6:00 PM (Cont.) | Administrative Law | Chair: Matthew Spitzer | ROOM 118/120 |
| | William N. Eskridge Jr., Connor Raso | Supreme Court Application of Deference Doctrine: Just Another Canon? | Elizabeth Garrett |
| | Michael W. Toffel, Jodi L. Short | Coming Clean and Cleaning Up: Is Voluntary Self-Reporting a Signal of Effective Self-Policing? | Simon Wilkie |
| | Medical Malpractice II | Chair: Brian Chen | ROOM 130 |
| | Michael Frakes | Defensive Medicine and Obstetric Practices | Seth A. Seabury |
| | J. Mark Ramseyer | The Effect of Universal Health Insurance on Malpractice Claims: The Japanese Experience | Jennifer Arlen |
| | Law and Politics IV | Chair: Christopher Berry | ROOM 101 |
| | Anthony M. Bertelli, Peter John | Government Checking Government: How Performance Measures Expand Distributive Politics | Christopher Berry |
| | Royce Carroll, Jeffrey B. Lewis, James Lo, Keith T. Poole, Howard Rosenthal | The Structure of Utility in Spatial Models of Voting | Andrew Martin |
| | Patents | Chair: Dave Fagundes | ROOM 2 |
| | Zhen Lei, Brian D. Wright | Why Weak Patents? Rational Ignorance or Pro-'Customer' Tilt? | Jonathan Barnett |
| | Albert G. Z. Hu, Ivan P.L. Png | Patent Rights and Economic Growth: Cross-Country Evidence | Michael D. Noel |

TOWN & GOWN

 REGISTRATION

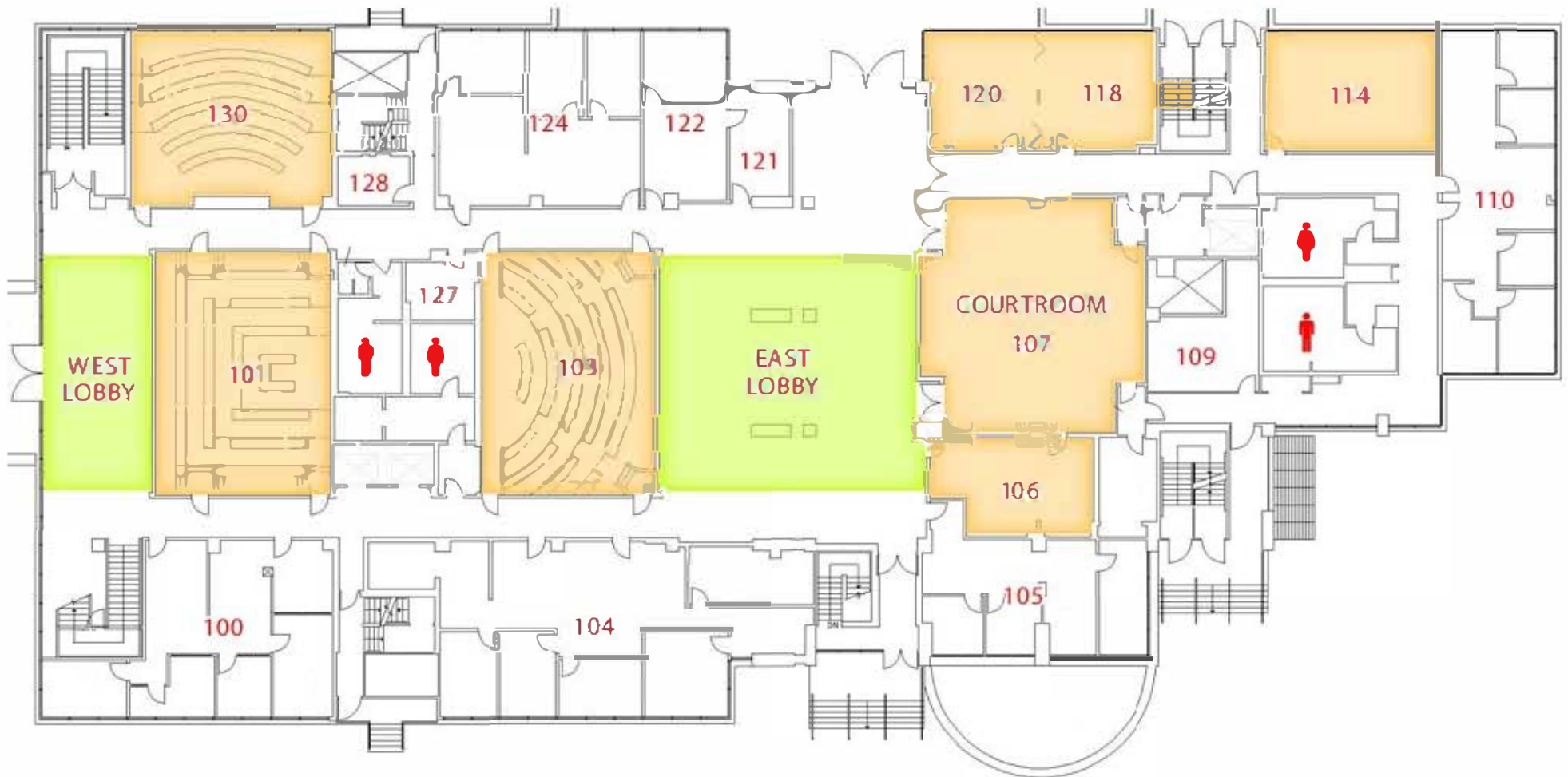

 **GOOD WIRELESS SIGNAL**

 **MEETING ROOM**

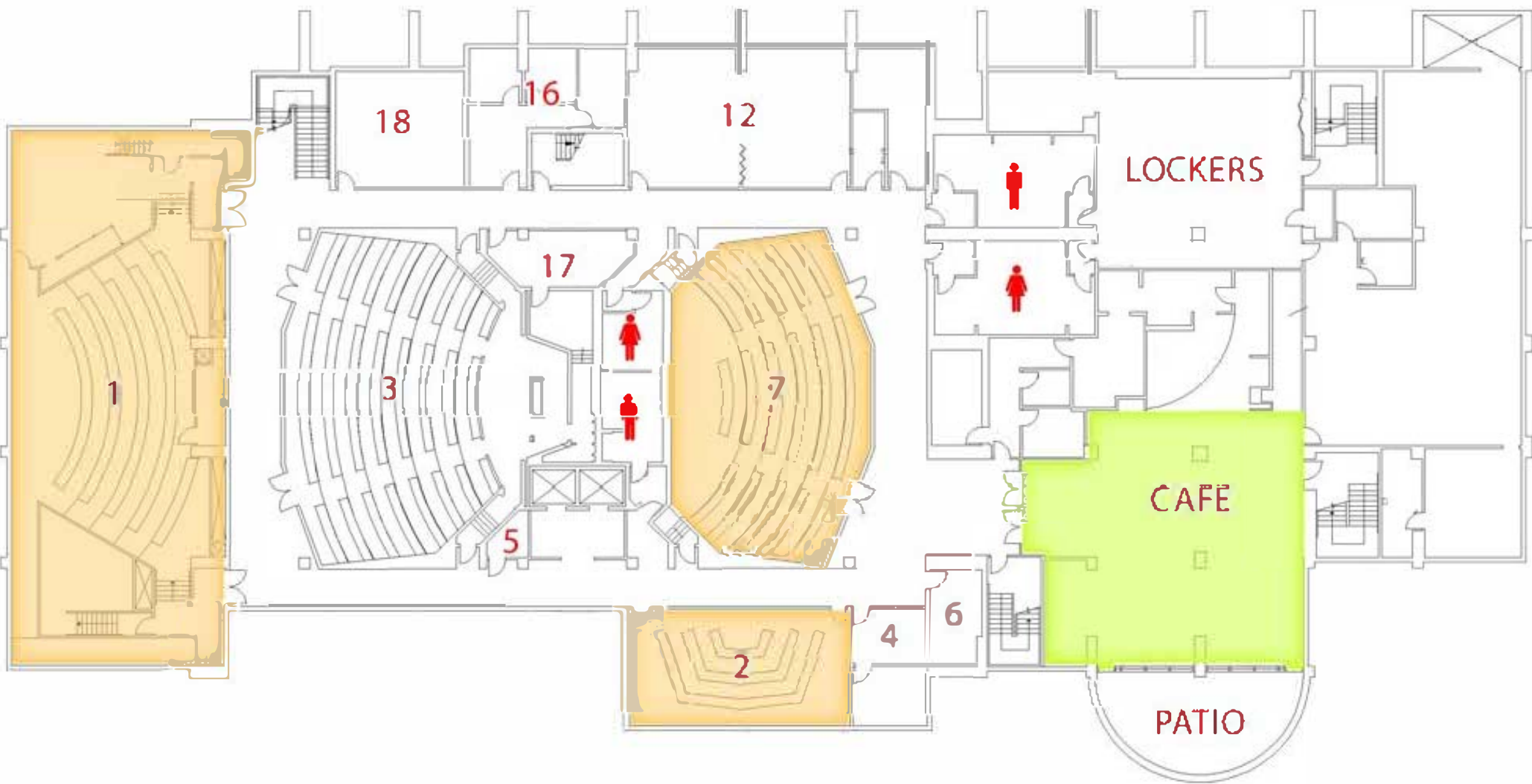

GOOD WIRELESS SIGNAL



MEETING ROOM

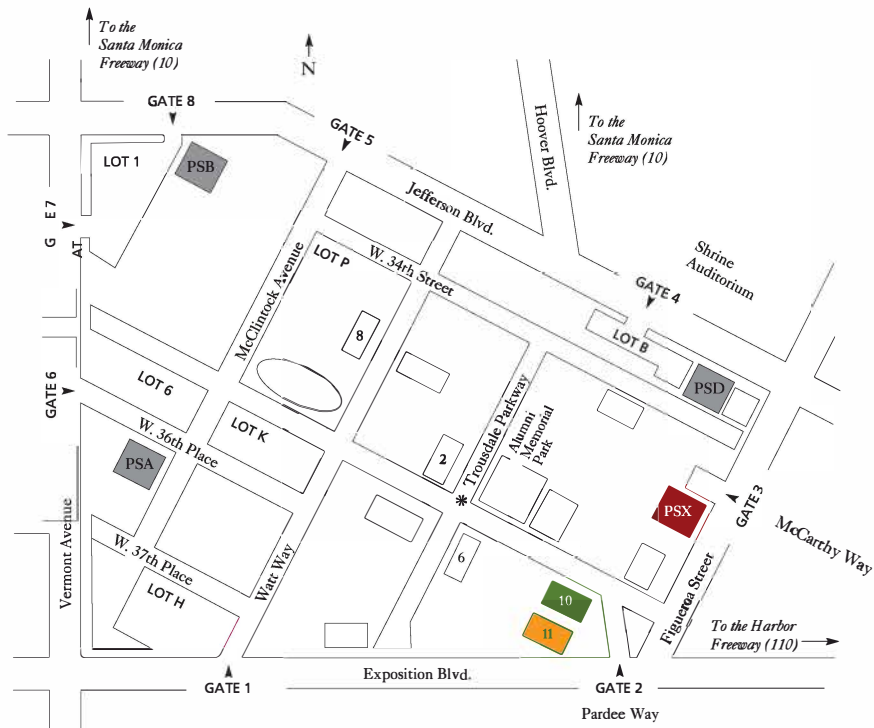

LEGEND

* Tommy Trojan

- 1 Queen's Court
- 2 Bovard Auditorium
- 3 Davidson Conference Center
- 4 Doheny Library
- 5 Hoose Library
- 6 Newman Hall
- 7 Leavey Library
- 8 Heritage Hall
- 9 Commons / Bookstore
- 10 Town & Gown
- 11 Gould School of Law
- PSX Parking Structure X

Transportation

Conference on Empirical Legal Studies (CELS) at USC Gould School of Law

- ◆ **Fast Deer Shuttle Service to/from:** Omni Los Angeles Hotel
251 S. Olive Street
Los Angeles, California
(213) 617-3300

Schedule

Friday, November 20 (*Continental Breakfast & Registration are 8:45 – 9:45 a.m.*)

Morning Departures from Omni Hotel 8:15 a.m.
8:30 a.m.
8:45 a.m.
9:15 a.m.

Evening Departures from USC Campus (Gate #2)..... 7:15 p.m.
7:45 p.m.
8:15 p.m.
8:45 p.m.
9:15 p.m.

Saturday, November 21 (*Continental Breakfast runs 7:30 – 9:00 a.m.*)

Morning Departures from Omni Hotel 7:15 a.m.
7:30 a.m.
7:45 a.m.
8:15 a.m.
8:45 a.m.

Evening Departures from USC Campus (Gate #2)..... 6:00 p.m.
6:30 p.m.

- ◆ **Taxi Service:** **Yellow Cab (213) 808-1000**
*USC Law School pick up address is 699 Exposition Blvd.
(at Pardee Way – Campus Gate #2).*

4th Annual Conference on Empirical Legal Studies

Society for Empirical Legal Studies

Chairman: Bernard Black

Co-Presidents: Daniel Klerman and Mathew McCubbins

U.S.C. Organizing Committee: Gillian Hadfield, Daniel Klerman, Thomas Lyon, Mathew McCubbins, Dan Simon, and Matthew Spitzer

Board of Directors: Jennifer Arlen, Bernard Black, Shari Seidman Diamond, Theodore Eisenberg, Dame Hazel Genn, Valerie Hans, Daniel Klerman, , Mathew McCubbins, Geoffrey Miller, and Roberta Romano

Conference Administrators: Marie Cleaves and Mira Dalpé

Acknowledgements:

The Board Members and the USC Organizing Committee would like to express gratitude to Dean Robert Rasmussen for enabling the USC Gould School of Law to host the Fourth Annual Conference on Empirical Legal Studies. The Board and Organizing Committee also thank the alumni for their charitable donations which made this Conference possible. Additionally, the committee recognizes Mira Dalpé, Marie Cleaves and their staff for their hard work on the conference. The committee also thanks the USC Computing Department for creating the webcast which allows the conference to be viewed by individuals unable to attend the conference. Lastly, the committee thanks everyone else who contributed to the conference, including reviewers, presenters, discussants, chairs, and attendees.





UNIVERSITY OF SOUTHERN CALIFORNIA

Gould School of Law

